

## THELEMA 80W POD MOD USER MANUAL

### SAFETY WARNING & INSTRUCTIONS

Please read this user manual carefully before using the product and keep the product in a safe place:

**1.Warning for vulnerable consumer groups:** The sale and use of e-cigarettes is prohibited for people under the age of 21. The use of e-cigarettes and liquids during pregnancy and breastfeeding, or by a non-smoker is not recommended. Keep this e-cigarette and its components out of the reach from children.

**2.Battery Caution:** Do not expose the device to extreme temperatures. Do not disassemble the device to service or change the battery without Lost Vape's recommendation. Contact Lost Vape or an authorized repair centre for battery servicing. Only dispose of Lithium Polymer batteries at a suitable waste disposal facility.

**3. E-liquid Use:** To use this product, e-liquid must be filled into the tank/pod—as explained below. ONLY E-LIQUIDS WHICH COMPLY WITH EUROPEAN UNION LAW, AND OTHER RELEVANT LAW, SHOULD BE USED IN THIS PRODUCT. Please consult with reputable e-cigarette and e-liquid dealer for advice on what e-liquids can be used in this product.

**4. Verify The Authenticity:** Please verify that the product is an authentic Lost Vape product before purchasing it. Fake and shoddy products may damage your personal health. To verify the product, please refer to <https://lostvape.com/anti-counterfeit/> and follow the steps described in the New Verification System. If you have any questions, please contact us by email, phone or our website to get help.

**5. Pod Cartridge Attention:** Do not dry burn the pod or coil. It is essential to fully saturate the cotton when having filled or refilled an empty pod. Thelema coils are not covered under warranty once they are opened, used, or filled with liquids.

**6. Contacts:** For further questions or inquiries, please contact Lost Vape by email at [support@lostvape.com](mailto:support@lostvape.com) or visit our website: [www.lostvape.com](http://www.lostvape.com).

**7.Warranty:** The device is covered by a 3-month warranty from the date of purchase. Please check our Warranty Guidelines for further information. Coils and/or accidental damages are not covered by this warranty.

### 1 MAIN FEATURE

- 80W MAX OUTPUT POWER
- ADJUSTABLE AIRFLOW
- Easy Top REFILL
- Type-C Charging

### 2 STANDARD PACKAGE

- 1× Thelema Kit
- 1× Pod (4ML Pre-installed)
- 1× 0.3Ω ULTRA BOOST M1 Mesh Coil
- 1× 0.2Ω ULTRA BOOST M4 Mesh Coil (Pre-installed)
- 1× Warranty Card
- 1× User Manual
- 1× USB-C Cable

### 3 BASIC PARAMETERS

Dimension	101mm×35.3mm×29.4mm
Weight	152g
Battery	3000 mAh Built-in Lithium Battery
Battery Voltage	3.0V-4.2V
Output Voltage	0.6V-4.0V
Power Range	5-80W
Current Range	0.3A-22A
Coil Resistance Supported Range	0.12Ω-5.0Ω
Screen Pixel	0.96" 108*217
Body Material	Zinc Alloy

### 4 COMPONENTS OVERVIEW

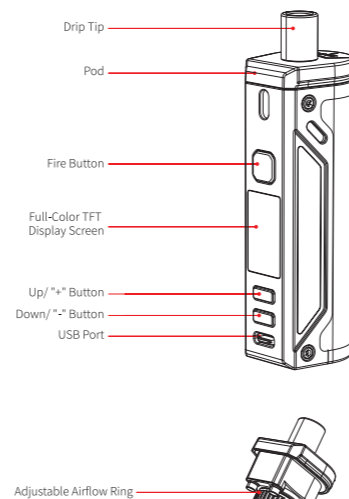

### 5 BASIC OPERATION

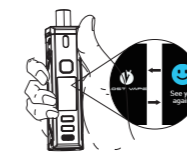

#### ● TURN ON/TURN OFF

Press the Fire button 5 times consistently within 2 seconds to TURN ON/TURN OFF the device. Without any operations, screen will be darkened in 10s, and it will turn into sleep mode in another 10s.

#### ● SET UP

Using the Up (+) and Down (-) buttons to adjust the wattage under POWER mode to the desired value.



@lost\_vape

@lost\_vape

[www.lostvape.com](http://www.lostvape.com)

#### ● WATTAGE LOCK/UNLOCK

Press and hold the Up (+) and Down (-) button at the same time to Lock and Unlock the wattage setting.

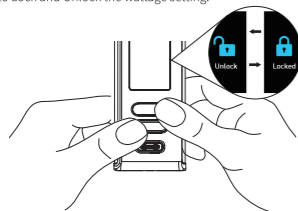

#### ● PUFF TIME and PUFF COUNT RESET

Press and hold the Fire and Down (-) button at the same time to reset the puff time and puff count.

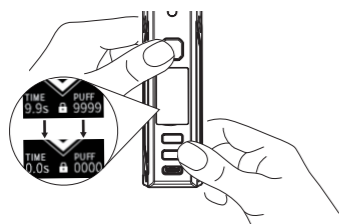

#### ● SCREEN COLOR CHANGE

Press and hold the Fire and Up (+) button at the same time to change the color theme.

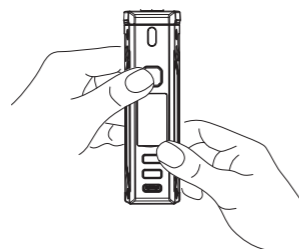

#### ● CHARGING

The device has a built-in DC 5V USB port. Connect the micro USB cable to a power source, the battery icon will begin to animate and stop animating once fully charged (Battery Voltage ≥ 4.18V).

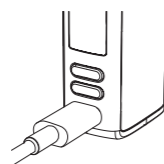

### 6 HOW TO FILL WITH E-LIQUID

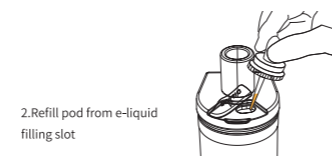

### 7 HOW TO REPLACE COIL

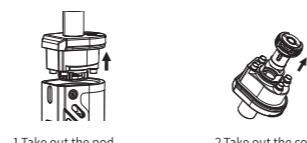

#### ATTENTION:

1.Make sure the pod is upside down before pull out the coil when there is juice still left in the pod to avoid leakage of the e-liquid.

### 8 DESCRIPTION OF WARNING



**No pass-through:** Vaping is not allowed when the device is charging. The screen will show "No pass-through" if it is power on.

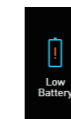

**Low Battery:** Output will automatically cut off and the screen will show "Low Battery". These messages means battery voltage below 3.2V before use or lower than 2.85V when you are using, this will continue to display for a few seconds after attempting to fire the device. Users should remove and replace the battery.



**Check Atomizer:** You will be asked to "Check Atomizer" when no atomizer detected, or the atomizer resistance is higher than 50.

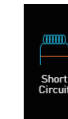

**Short Circuit:** When the atomizer resistance is lower than 0.12Ω, the screen displays "Shortcircuit" once you press the Fire button.



**Too Hot:** The device will shut down and display "TOO HOT" once the temperature of internal board is higher than 75°C. You can use the device again when the temperature is back to 60°C.



**Over 10s:** Output will automatically cut off and screen shows "Over 10s" when you fire over 10s continuously.