



UB LITE POD KIT USER MANUAL

SAFETY WARNING & INSTRUCTIONS

Please read this user manual carefully before using the product and keep the product in a safe place:

1. Warning for vulnerable consumer groups: The sale and use of e-cigarettes is prohibited for people under the age of 21. The use of e-cigarettes and liquids during pregnancy and breastfeeding, or by a non-smoker is not recommended. Keep this e-cigarette and its components out of the reach of children.

2. Battery Caution: Do not expose the device to extreme temperatures. Do not disassemble the device to service or change the battery without Lost Vape's recommendation. Contact Lost Vape or an authorized repair centre for battery servicing. Only dispose of Lithium Polymer batteries at a suitable waste disposal facility.

3. E-liquid Use: To use this product, e-liquid must be filled into the tank/pod—as explained below. ONLY E-LIQUIDS WHICH COMPLY WITH EUROPEAN UNION LAW, AND OTHER RELEVANT LAW, SHOULD BE USED IN THIS PRODUCT. Please consult with reputable e-cigarette and e-liquid dealer for advice on what e-liquids can be used in this product.

4. Verify The Authenticity: Please verify that the product is an authentic Lost Vape product before purchasing it. Fake and shoddy products may damage your personal health. To verify the product, please refer to <https://lostvape.com/anti-counterfeit/> and follow the steps described in the New Verification System. If you have any questions, please contact us by email, phone or our website to get help.

5. Pod Cartridge Attention: Do not dry burn the coil or cotton. It is essential to fully saturate the cotton when having filled or refilled an empty cartridge. The cartridges are not covered under warranty once they are opened, used, or filled with liquids.

6. Contacts: For further questions or inquiries, please contact Lost Vape by email at support@lostvape.com or visit our website: www.lostvape.com.

7. Warranty: The device is covered by a 3-month warranty from the date of purchase. Please check our Warranty Guidelines for further information. Coils and/or accidental damages are not covered by this warranty.

1 MAIN FEATURE

- 30W MAX OUTPUT POWER
- TYPE-C CHARGING
- AIRFLOW ADJUSTMENT
- EASY SIDE REFILL
- 1000MAH BUILT-IN BATTERY
- AUTO-DRAW SUPPORTED

2 STANDARD PACKAGE

- 1 × UB Lite Pod Device
- 1 × UB Lite Coil L1 0.4Ω (Pre-installed)
- 1 × Type-C USB Cable
- 1 × User Manual
- 1 × Pod (2ML Pre-installed)
- 1 × UB Lite Coil L5 1.4Ω
- 1 × Warranty Card
- 1 × Lanyard

3 BASIC PARAMETERS

Dimension	115mm × 20.6mm × 19.8mm
Weight	47.5g
Battery	1000mAh Battery (built-in)
Battery Voltage	3.0V-4.2V
Output Voltage	3.0V-4.0V
Power Range	7-30W
Current Range	2.0A-9.0A
Coil Resistance Supported Range	0.3Ω-3.0Ω
Body Material	Aluminium

4 COMPONENTS OVERVIEW

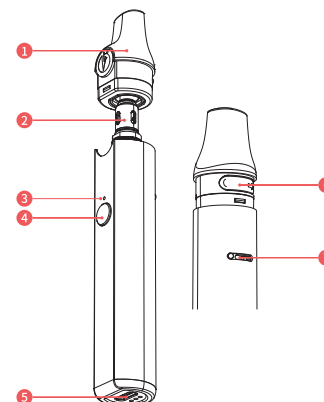

① Pod	⑤ TYPE -C Port
② Coil	⑥ E-liquid Refilling Plug
③ LED Indicator	⑦ Adjustable Airflow Control
④ Fire Button	

5 CHARGING INDICATION

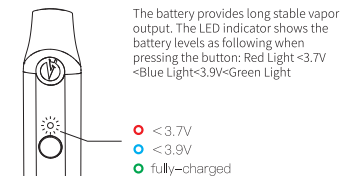

The battery provides long stable vapor output. The LED indicator shows the battery levels as following when pressing the button: Red Light <3.7V <Blue Light<3.9V<Green Light

- <3.7V
- <3.9V
- fully-charged

The device has a built-in DC 5V TYPE-C port. Connect the USB port to a power source, the LED Indicator will show with the above color refer to battery levels, and it will keep showing green once fully charged (Battery Voltage ≥ 4.2V).

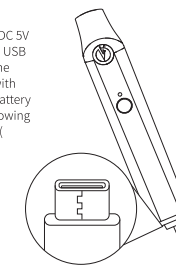

6 DEVICE OPERATION

● TURN ON/TURN OFF

Press the Fire button 5 times consistently within 2 seconds and with 5 times white flashing to TURN ON/ TURN OFF the device.

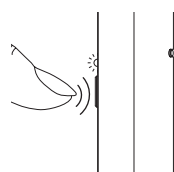

7 LOCK/UNLOCK DEVICE

● LOCK/UNLOCK DEVICE

Press the Fire button 3 times to Lock and Unlock the device. Draw activation will still be working with the fire button locked.

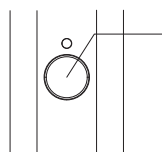

8 COIL DETECTION

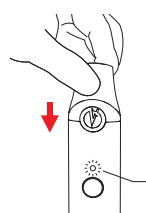

The device will automatically detect the coil resistance and provide the recommended power output. When installed a new coil, put the pod into the device, the LED indicator shows the coil resistances as following: Red Light-0.4Ω, Blue Light-0.8Ω, Green Light-1.4Ω.

- 0.4Ω
- 0.8Ω
- 1.4Ω

9 PROTECTION INDICATOR

Charging:

Vaping is not allowed and no vape response when the device is charging.

Low-Battery:

LED indicator will flash for 5 times and the output will automatically cut off once the battery voltage below 3.3V before use or lower than 3.0V when using.

Short-Circuit:

White light flashes 3 times when short-circuit occurred.

Open-circuit:

When no atomizer detected or open-circuit occurred, the indicator will flash for 3 times.

Over Time:

LED indicator will flash for 8 times and no power output when you vape over 10s continuously.

10 HOW TO FILL WITH E-LIQUID

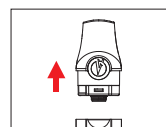

1. Take out the pod;

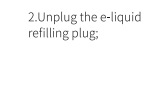

2. Unplug the e-liquid refilling plug;

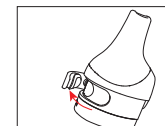

3. Refill pod from e-liquid filling slot;

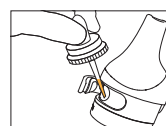

4. Seal the pod after filling;

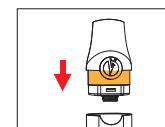

5. Put the pod back into the device.

11 HOW TO REPLACE COIL

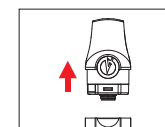

1. Take out the pod;



2. Take out the coil directly;

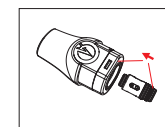

3. Push the new coil back into the pod in a correct way;



4. Put the pod back into the device.

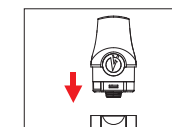

LOST VAPE®

@lost_vape

@lost_vape

www.lostvape.com